

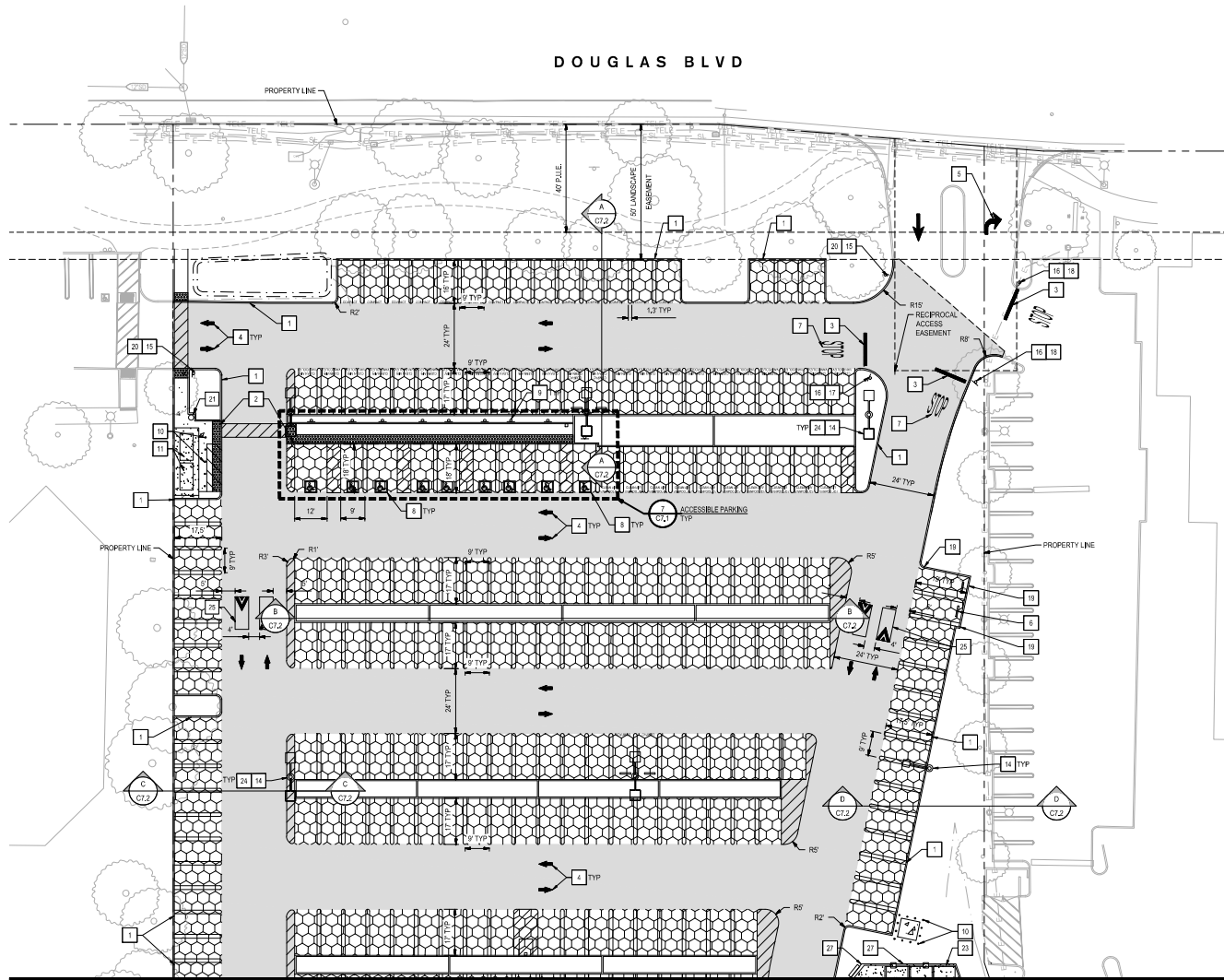



DOUGLAS BLVD

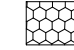

PAVEMENT LEGEND

-  CONCRETE FLATWORK
4.0" CONCRETE WITH FIBERMESH 650 (4.0 LBS/CY) OVER 4.0" CLASS II AGGREGATE BASE OVER 8.0" SUBGRADE COMPACTED TO 95% R.C. SUBGRADE PREPARED PER THE PROJECT'S GEOTECHNICAL MEMO
-  DRIVE AISLE PAVING T1=5.0, R=30
3.5" HOT MIX ASPHALT OVER 7.5" CLASS 2 AGGREGATE BASE OVER 12.0" SUBGRADE COMPACTED TO 95% R.C. SUBGRADE PREPARED PER THE PROJECT'S GEOTECHNICAL MEMO
-  PARKING SPACE PAVING T1=5.0, R=30
3.0" HOT MIX ASPHALT OVER 7.5" CLASS 2 AGGREGATE BASE (95% R.C.) OVER 12.0" SUBGRADE COMPACTED TO 95% R.C. SUBGRADE PREPARED PER THE PROJECT'S GEOTECHNICAL MEMO
ALTERNATE BID FOR ACCESSIBLE PARKING AREA
4.0" COURSE CONCRETE WITH #4 BARS AT 18" O.C. EA. WAY OVER 6.0" CLASS 2 AGGREGATE BASE (95% R.C.) OVER 12.0" SUBGRADE COMPACTED TO 95% R.C. SUBGRADE PREPARED PER THE PROJECT'S GEOTECHNICAL MEMO
-  CONEX YARD PAVING
BASE BID - HEAVY DUTY ASPHALT T1=7.0
6.0" HOT MIX ASPHALT OVER 6.0" CLASS II AGGREGATE BASE OVER 12.0" SUBGRADE COMPACTED TO 95% R.C. SUBGRADE PREPARED PER THE PROJECT'S GEOTECHNICAL MEMO. IF #4 BARS SELECTED FOR THE CONEX YARD, THE TURNED DOWN SLAB EDGE PER DETAIL 6 ON SHEET C7.4 SHALL BE INSTALLED
ALTERNATE BID - HEAVY DUTY CONCRETE
6.0" COURSE CONCRETE WITH #4 BARS @ 18" O.C. OVER 6.0" CLASS II AGGREGATE BASE OVER 12.0" SUBGRADE COMPACTED TO 95% R.C. SUBGRADE PREPARED PER THE PROJECT'S GEOTECHNICAL MEMO
-  ACCESSIBLE PATH OF TRAVEL

KEY NOTES

- 1 6" VERTICAL CURB PER DETAIL 1 ON SHEET C7.1
- 2 FLUSH CURB WITH TRUNCATED DOMES, PER DETAIL 5 ON SHEET C7.2
- 3 24" WIDE THERMOPLASTIC STOP LINE PER MUTCD SECTION 3B.16
- 4 TYPE I THERMOPLASTIC STRIPING ARROW PER MUTCD FIGURE 3B-24(CA)
- 5 TYPE IV THERMOPLASTIC STRIPING ARROW PER MUTCD FIGURE 3B-24(CA) LEFT OR RIGHT PER PLAN
- 6 4" WHEEL STOP PER DETAIL 2 ON SHEET C7.2
- 7 *STOP MARKING PER MUTCD SECTION 3B.20
- 8 ACCESSIBLE PARKING SYMBOL PER DETAIL 4 ON SHEET C7.3
- 9 ACCESSIBLE PARKING SIGNAGE PER DETAIL 7 ON SHEET C7.2
- 10 STEEL BOLLARDS PER DETAIL 8 ON SHEET C7.3
- 11 BUS SHELTER PER DETAIL 4 ON SHEET C7.4
- 12 4" YELLOW STRIPING, STANDARD PAINT
- 13 20' OMEGA II SINGLE CANTILEVER SLIDE GATE PER DETAILS 1 AND 2 ON SHEET C7.4
- 14 LIGHT POLE
- 15 TOW SIGN PER DETAIL 6 ON SHEET C7.3
- 16 PROPOSED *STOP SIGN PER MUTCD STANDARDS
- 17 PROPOSED *CROSS TRAFFIC DOES NOT STOP SIGN
- 18 PROPOSED *ONCOMING TRAFFIC DOES NOT STOP SIGN
- 19 30" RETAINING WALL PER DETAIL 10 ON SHEET C7.3
- 20 DIRECTIONAL SIGNAGE PER SPECIFICATION SECTION 10 14 02
- 21 TRASH RECEPTACLE - LANDSCAPE FORMS 'AUSTIN LITTER' SIDE OPEN 34 GAL. POWDER COATED SILVER
- 22 EAS-SET EQUIPMENT BUILDING PER ARCHITECTURAL SHEETS A-200-A-1
- 23 OMEGA D LOUVERED FENCE PER DETAILS 3, 5, AND 6 ON SHEET C7.4
- 24 INSTALL VIDEO SURVEILLANCE SIGN
- 25 SPEED CUSHION PER DETAIL 5 ON SHEET C7.3
- 26 OMEGA 80 SINGLE SWING GATE PER DETAIL 7 ON SHEET C7.4
- 27 TURNED DOWN SLAB EDGE PER DETAIL 6 ON SHEET C7.4

STRIPING NOTES

1. THERMOPLASTIC STRIPING SHALL CONFORM TO CALTRANS STANDARD SPECIFICATION SECTION 84-2.01 AND 84-2.03B.



- NOTES
1. ALL EXISTING UTILITIES WERE PLOTTED FROM RECORD INFORMATION AND FIELD TOPOGRAPHY. ACTUAL LOCATIONS MAY VARY AND ADDITIONAL CROSSINGS MAY EXIST IN THE FIELD. IT IS IMPERATIVE THAT ALL A LOCATING SERVICES LOCATE AND MARK EXISTING UTILITIES PRIOR TO THE START OF EXCAVATION.
 2. THE CONTRACTOR SHALL USE EXTREME CAUTION WHEN EXPOSING EXISTING UTILITY CROSSINGS AND SERVICES.
 3. ANY DAMAGE TO EXISTING UTILITIES WILL BE THE SOLE RESPONSIBILITY OF THE CONTRACTOR.

SIEGFRIED
900 Howe Ave., Suite 200
Sacramento, CA 95825
916-450-0777
www.siegfriedeng.com

- CIVIL
- STRUCTURAL
- LANDSCAPE ARCHITECTURE
- SURVEYING



REVISIONS

No.	Date	Description
1	6/8/2021	PLANNING DEPARTMENT BC #2

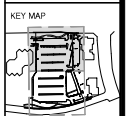

PROJECT
KAISER PERMANENTE ROSEVILLE TEMPORARY PARKING LOT
9135 DOUGLAS BLVD, ROSEVILLE, CA 95661

CW/M TBD
BD/ TBD
EN/ TBD



DATE SIGNED: 06/08/21

SHEET TITLE





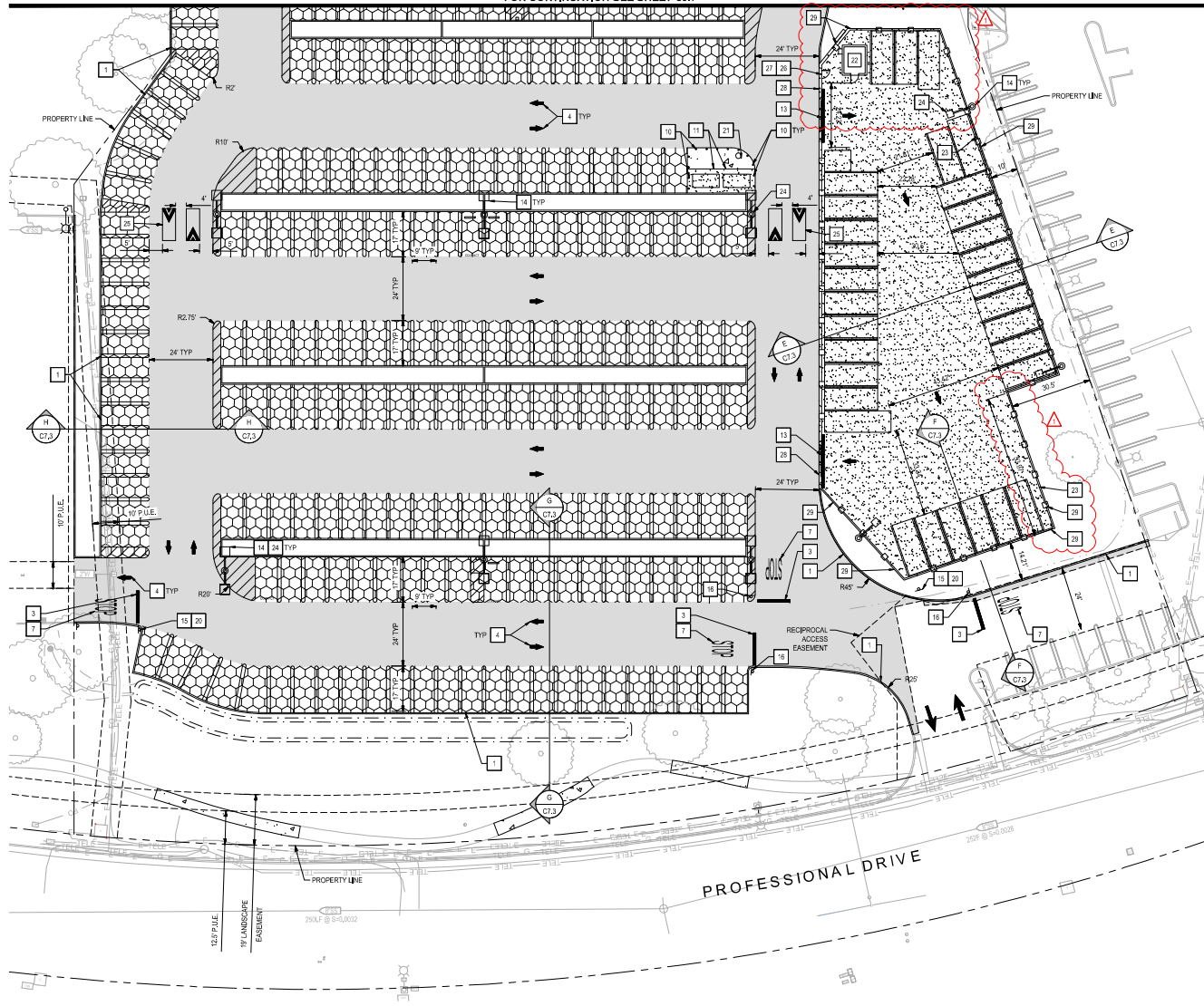

PAVING & DIMENSIONING PLAN I

Proj Mgr: PJS
Drawn by: RRQ
Date: 6/8/2021
Job No.: 20110
SHEET: C3.1

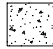
FOR CONTINUATION SEE SHEET C3.1

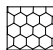

PAVEMENT LEGEND

-  CONCRETE FLATWORK:
4" CONCRETE WITH FIBER MESH 650 (4.0 LBS/CY), OVER 4.0" CLASS II AGGREGATE BASE OVER 8.0" SUBGRADE COMPACTED TO 98% R.C., SUBGRADE PREPARED PER THE PROJECT'S GEOTECHNICAL MEMO
-  DRIVEABLE PAVING: TH-5.0, R-30
3.0" HOT MIX ASPHALT OVER 7.5" CLASS 2 AGGREGATE BASE OVER 12.0" SUBGRADE COMPACTED TO 98% R.C., SUBGRADE PREPARED PER THE PROJECT'S GEOTECHNICAL MEMO
-  PARKING SPACE PAVING: TH-5.0, R-30
3.0" HOT MIX ASPHALT OVER 7.5" CLASS 2 AGGREGATE BASE OVER 12.0" SUBGRADE COMPACTED TO 98% R.C., SUBGRADE PREPARED PER THE PROJECT'S GEOTECHNICAL MEMO
-  ALTERNATE BID FOR ACCESSIBLE PAVING AREA
4" 3.000PS CONCRETE WITH #4 BARS AT 18" O.C. EA. WAY OVER 5.5" CLASS 2 AGGREGATE BASE (95% R.C.) OVER 12.0" SUBGRADE COMPACTED TO 98% R.C., SUBGRADE PREPARED PER THE PROJECT'S GEOTECHNICAL MEMO
-  CONEX YARD PAVING
BASE BID: HEAVY DUTY ASPHALT: TH-7.0
6.0" HOT MIX ASPHALT OVER 6.0" CLASS II AGGREGATE BASE OVER 12.0" SUBGRADE COMPACTED TO 98% R.C., SUBGRADE PREPARED PER THE PROJECT'S GEOTECHNICAL MEMO. IF AC IS SELECTED FOR THE CONEX YARD, THE TURNED DOWN SLAB EDGE PER DETAIL 8 ON SHEET C7.4 SHALL BE INSTALLED
-  ALTERNATE BID: HEAVY DUTY CONCRETE
6" 3.000PS CONCRETE WITH #5 BARS @ 18" O.C. OVER 6.0" CLASS II AGGREGATE BASE OVER 12.0" SUBGRADE COMPACTED TO 98% R.C., SUBGRADE PREPARED PER THE PROJECT'S GEOTECHNICAL MEMO

KEY NOTES

- 1 6" VERTICAL CURB PER DETAIL 1 ON SHEET C7.1
- 2 FLUSH CURB WITH TRUNCATED DOMES, PER DETAIL 6 ON SHEET C7.0
- 3 24" WIDE THERMOPLASTIC STOP LINE PER MUTCD SECTION 3B.16
- 4 TYPE IV THERMOPLASTIC STRIPING ARROW PER MUTCD FIGURE 3B-24(CA)
- 5 TYPE IV THERMOPLASTIC STRIPING ARROW PER MUTCD FIGURE 3B-24(CA) LEFT OR RIGHT PER PLAN
- 6 4" WHEEL STOP PER DETAIL 2 ON SHEET C7.0
- 7 *STOP* MARKING PER MUTCD SECTION 3B.20
- 8 ACCESSIBLE PARKING SYMBOL PER DETAIL 4 ON SHEET C7.0
- 9 ACCESSIBLE PARKING SIGNAGE PER DETAIL 7 ON SHEET C7.0
- 10 STEEL BOLLARDS PER DETAIL 8 ON SHEET C7.0
- 11 BUS SHELTER PER DETAIL 4 ON SHEET C7.4
- 12 4" YELLOW STRIPING, STANDARD PAINT
- 13 20" OMEGA II SINGLE CANTILEVER SLIDE GATE PER DETAILS 1 AND 2 ON SHEET C7.4
- 14 LIGHT POLE
- 15 TOW SIGN PER DETAIL 6 ON SHEET C7.0
- 16 PROPOSED *STOP* SIGN, PER MUTCD STANDARDS
- 17 PROPOSED *CROSS TRAFFIC DOES NOT STOP* SIGN
- 18 PROPOSED *ONCOMING TRAFFIC DOES NOT STOP* SIGN
- 19 30" RETAINING CURB PER DETAIL 10 ON SHEET C7.0
- 20 DIRECTIONAL SIGNAGE PER SPECIFICATION SECTION 10 14 02
- 21 TRASH RECEPTACLE - LANDSCAPE FORMS 'AUSTIN LITTER' SIDE OPEN 34 GAL. POWDER COATED SILVER
- 22 EAS-SET EQUIPMENT BUILDING PER ARCHITECTURAL SHEETS A-0.0-A-1
- 23 OMEGA II COVERED FENCE PER DETAILS 3, 5 AND 6 ON SHEET C7.4
- 24 INSTALL VIDEO SURVEILLANCE SIGN
- 25 SPEED CUSHION PER DETAIL 9 ON SHEET C7.0
- 26 OMEGA 80 SINGLE SWING GATE PER DETAIL 7 ON SHEET C7.4
- 27 INSTALL MOUNTED ON THE GATE A SIGN STATING 'EMERGENCY USE ONLY - ALARM WILL SOUND'
- 28 NO THICKENED EDGE REQUIRED ON CONEX YARD
- 29 TURNED DOWN SLAB EDGE PER DETAIL 8 ON SHEET C7.4

STRIPING NOTES

1. THERMOPLASTIC STRIPING SHALL CONFORM TO CALTRANS STANDARD SPECIFICATION SECTION 8A-2.01 AND 8A-2.03B.

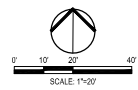

- NOTES**
1. ALL EXISTING UTILITIES WERE PLOTTED FROM RECORD INFORMATION AND HELD TOPOGRAPHY. ACTUAL LOCATIONS MAY VARY AND UTILITARIAN CROSSINGS MAY OBTAIN IN THE FIELD. IT IS INTERFERING THAT ALL A LOCATING SERVICES LOCATE AND MARK EXISTING UTILITIES PRIOR TO THE START OF EXCAVATION.
 2. THE CONTRACTOR SHALL USE EXTREME CAUTION WHEN EXPOSING EXISTING UTILITY CROSSINGS AND SERVICES.
 3. ANY DAMAGE TO EXISTING UTILITIES WILL BE THE SOLE RESPONSIBILITY OF THE CONTRACTOR.



SIEGFRIED
900 Howe Ave., Suite 200
Sacramento, CA 95825
916-490-7777
www.siegfriedeng.com

- CIVIL
- STRUCTURAL
- LANDSCAPE ARCHITECTURE
- SURVEYING



REVISIONS

No.	Date	Description
1	6/8/2021	PLANNING DEPARTMENT #C 02

KEY MAP

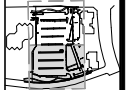

PROJECT
KAISER PERMANENTE
ROSEVILLE
TEMPORARY
PARKING LOT
2135 DOUGLAS BLVD.,
ROSEVILLE, CA 95661

CW# TBD
SD# TBD
EN# TBD



DATE SIGNED: 06/08/21

SHEET TITLE

PAVING & DIMENSIONING PLAN II

Proj Mgr: PJS
Drawn by: RRQ
Date: 6/8/2021
Job No.: 20110
SHEET: **C3.2**